

Schottky Barrier Power Rectifiers

Using the Schottky Barrier principle with a Molybdenum barrier metal. These state-of-the-art geometry features epitaxial construction with oxide passivation and metal overlay contact. Ideally suited for low voltage, high frequency rectification, or as free wheeling and polarity protection diodes.

Features

- * Low Forward Voltage.
- * Low Switching noise.
- * High Current Capacity
- * Guarantee Reverse Avalanche.
- * Guard-Ring for Stress Protection.
- * Low Power Loss & High efficiency.
- * 150°C Operating Junction Temperature
- * Low Stored Charge Majority Carrier Conduction.
- * Plastic Material used Carries Underwriters Laboratory
- * ESD: 4KV(Min.) Human-Body Model



* In compliance with EU RoHs 2002/95/EC directives

SCHOTTKY BARRIER RECTIFIERS

**8 AMPERES
70-100 VOLTS**

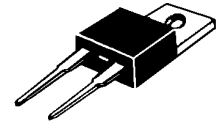

TO-220A

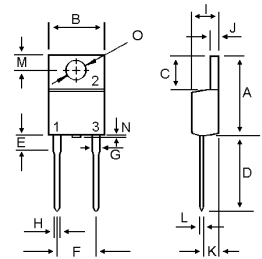

DIM	MILLIMETERS	
	MIN	MAX
A	14.68	16.00
B	9.78	10.42
C	5.02	6.60
D	13.00	14.62
E	3.10	4.19
F	4.82	5.34
G	1.10	1.67
H	0.69	1.01
I	3.21	4.98
J	1.14	1.40
K	2.20	3.30
L	0.28	0.61
M	2.48	3.00
N	---	1.00
O	3.50	4.00

MAXIMUM RATINGS

Characteristic	Symbol	S08A				Unit
		70	80	90	100	
Peak Repetitive Reverse Voltage Working Peak Reverse Voltage DC Blocking Voltage	V_{RRM} V_{RWM} V_R	70	80	90	100	V
RMS Reverse Voltage	$V_{R(RMS)}$	49	56	63	70	V
Average Rectifier Forward Current	$I_{F(AV)}$	8				A
Peak Repetitive Forward Current (Rate V_R , Square Wave, 20kHz)	I_{FM}	16				A
Non-Repetitive Peak Surge Current (Surge applied at rate load conditions halfwave, single phase, 60Hz)	I_{FSM}	150				A
Operating and Storage Junction Temperature Range	T_J, T_{STG}	-65 to +150				°C

ELECTRICAL CHARACTERISTICS

Characteristic	Symbol	S08A				Unit
		70	80	90	100	
Maximum Instantaneous Forward Voltage ($I_F = 8$ Amp $T_C = 25^\circ C$) ($I_F = 8$ Amp $T_C = 125^\circ C$)	V_F	0.75 0.68		0.85 0.72		V
Maximum Instantaneous Reverse Current (Rated DC Voltage, $T_C = 25^\circ C$) (Rated DC Voltage, $T_C = 125^\circ C$)	I_R	0.2 20				mA

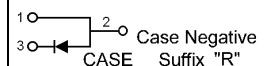
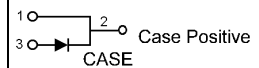

FIG-1 FORWARD CURRENT DERATING CURVE

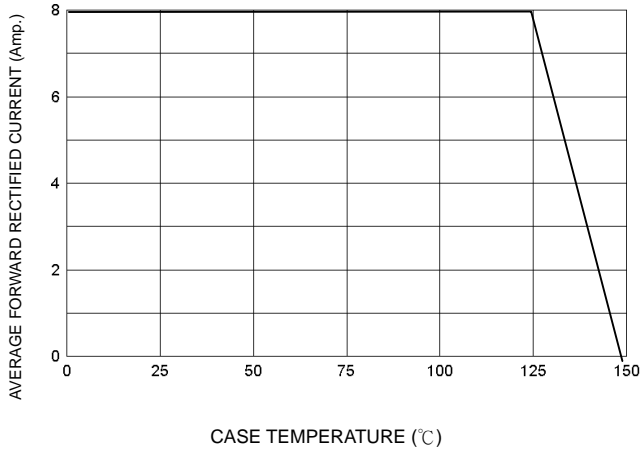

FIG-2 TYPICAL FORWARD CHARACTERISTICS

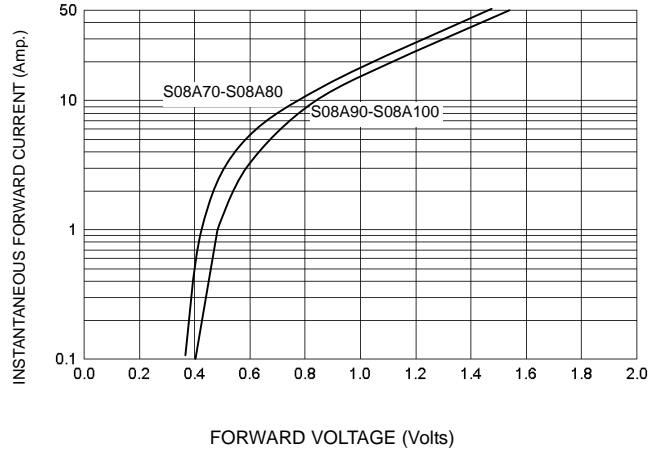

FIG-3 TYPICAL REVERSE CHARACTERISTICS

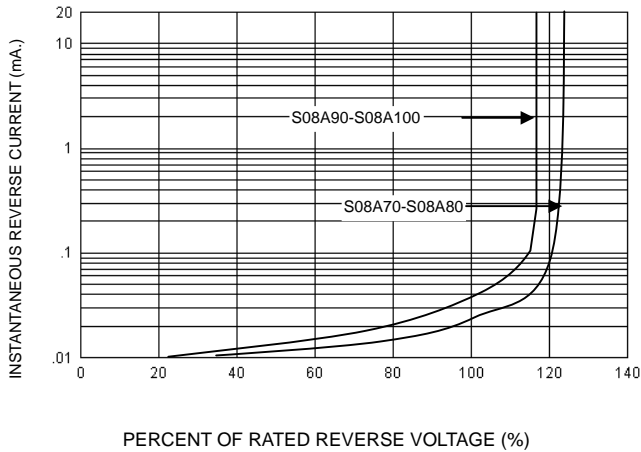

FIG-4 TYPICAL JUNCTION CAPACITANCE

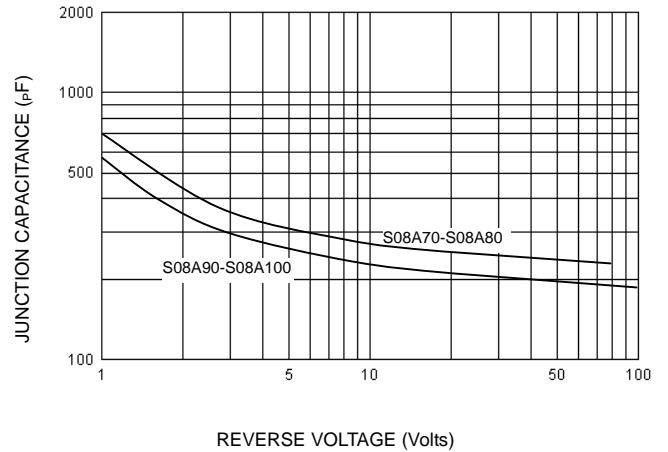

FIG-5 PEAK FORWARD SURGE CURRENT

